

THE WOODEN BOAT
ASSOCIATION OF QUEENSLAND inc
Celebrating the diversity and enjoyment of Wooden Boats

THE LOG

Wooden Boat Association of Queensland Inc
P.O. Box 210 Mt Ommaney Q 4074
Email: info@woodenboat.org.au
Web: <http://www.woodenboat.org.au>

NOVEMBER 2017



THE SOLO SAILOR

Unknown

I am the captain of my craft

My word is law from fore to aft,

I am the cook and steward too,

I am the passengers and the crew,

And though 'tis said I'm hard to please.

I'm not afraid of mutinies;

In fact, my complement at sea

Is as perfect as it can be."



THE WOODEN BOAT ASSOCIATION QLD 2018 CALENDAR IS OUT! ONLY \$10
You get a new boating picture each month; 12 boating words of wisdom to think about
and a space to write and plan for each day.
These make a wonderful Christmas Gift.



Wooden Boat Assn Qld Committee

- **President** Jim Jones 0408 443 291
- **Vice-President** Jon Elcock 0413 945 377
- **Secretary** Phil Brown 0416 057 277
- **Treasurer** Wayne Aberdeen 0418 752 523
- **M'ship Secretary** Ed Elcock 0400 885 103
- **Webmaster** John Tennock
webmaster@woodenboat.org.au
- **Web content/ Publicity**
Malcolm Hodgen
- **Committee** Ian Trail, Doug Graham, Ian Primrose (Log Editor), Peter Jensen
- **Events sub-committee** –Phil Brown
- **Messabout Co-ordinator**
Darrell Spiers 3298 5394
- **Librarian** – Mac Finch
- **Merchandise** Leo Sines

Regular Meetings and Activities

Meetings are held at 7.00 pm on the second Tuesday of the month (except January) at the Queensland Maritime Museum, following a BBQ at 6.00pm. Bring along your plans, projects and problems for group attention. Don't forget something for **SHOW, TELL & ASK**. The Committee meeting is held at Queensland Maritime Museum at 4:00 pm prior to the BBQ meeting. Workshop Working Bees are on hold until further notice.

Entry to the Museum for meetings and workshop days is off Dock Street, via the emergency vehicle gate between the cycle path and the old timber Dock building. Use intercom for entry.

Messabouts are held monthly. For details of these and other wooden boat events, refer to the calendar of events later in this newsletter

Sub-Committees

Messabout Calendar

info@woodenboat.org.au

St Ayles Skiff Sub-committee

Steven Ainscough- Leader

communityrowingqld@gmail.com

Provedores Ian Trail & Mac Finch

Editor's Note

Your contributions to the LOG are sought and welcomed. Articles in MS word with JPEG photos are the preferred format. Email if possible. The Log is generally finalised the day after the monthly meeting. Editor Ian Primrose
Phone 3263 3381 m 0491 120 888 Contributions to:
imprimrose@powerup.com.au

WBAQ Disclaimer

Opinions and Advice: Opinions and advice expressed in "The Log" and the Association's meetings are those of the individual originator's only. The Editor and the Association's Committee do not necessarily endorse views expressed at such forums.

Participation in Events: Participation in events organised by the Association may involve certain risks inherently associated with the perils of the sea or weather which include the possibility of damage to, or loss of, vessels and equipment, as well as injury or death to persons. Such risks will require the exercise of the prior judgment of members on behalf of themselves, their guests and invitees, whether to commence or continue any particular activity irrespective of information supplied by the Association, its Committee or officers. The Association, its Committee and officers accept no responsibility for damage, loss, injury or death arising from these risks.

Contributions to "The Log": Contributions to "The Log" by members of the Association on relevant topics are most welcome. Contributions may be edited before publication at the Editor's discretion. By submitting any material for publication the Contributor warrants that he/she is the copyright owner, and consents to both the editing of the material and its publication in 'The Log' and on the Association's website, on a royalty free basis.

Header Photo by Paul Hernes
Boats early morning at Lake Cootharaba 2017

(Press Control [ctrl] & Click to access active links in the LOG or copy to your search engine)

FROM THE CAPTAIN'S CABIN

Jim Jones, President

On the last Sunday in October, three Members with boats in tow visited Caloundra to help celebrate the 40th Anniversary of the Caloundra Power Boat Club. *Playstation 2*, *Sea Lark* and Darrell's Wes Farmer dinghy were on display outside the entrance to the Club. QF4 Caloundra Coast Guard also displayed one of their Rescue Boats on the grass on the shore of Pumicestone Passage. We were all welcomed by the Club with open arms. The Club was a hive of activity with free entertainment for the younger visitors. As on previous occasions where we have had boats on display, our three boats attracted plenty of comment from young and old. What is it about a wooden boat that draws people to touch and feel and not just look? Maybe it is the warm feeling of timber against the cold hard feeling of a metal or plastic boat.

(See Photo Page 9)

On Thursday 2nd November, Jon, Ed and I had a meeting with the Breakfast Creek Boat Club. The BCBC have been in talks with the Brisbane City Council regarding the lease of an area of land in Argyle Street, Albion. The Council previously had a workshop on that land which is no longer in use. The Council would like to have the area and the buildings used by a community organisation.

The meeting we had was a preliminary meeting to determine if our two groups would have a common interest and be able to utilise the buildings. The building at this stage has toilets, a kitchen area, a partitioned office area and open workshop areas. It was envisaged that a meeting room be developed along with a workshop area for boat building.

A large grassed area partly shaded by a large Fig tree is on the Northern side of the buildings. The land has direct frontage to Breakfast Creek. There are approximately thirty "on street" parking spaces. Several boat building and repair business are located in the area. If the WBAQ were to enter into an arrangement with the BCBC and the BCC, we would have a base to build or repair boats, provide boat building demonstrations and or lessons and an area to enable us to accept boats that have been offered to the WBAQ.

Cheers

JIM

UNDER CONSTRUCTION

This segment is provided for members to liaise with builders of boats that they themselves may be interested in building.

Jeff Bailey's Selway Fisher 'Woodland' sailing canoe is progressing well with the lapstrake hull complete and the inner whale installed. The buoyancy tanks are currently being created

UPDATED Ed Elcock with son James is in the process of finishing an Argie 15 designed by Dudley Dix as a low-powered motor boat...The preparation and filling of the various buoyancy chambers has been the main concentration of effort this month. The buoyancy occurs at the stern, amidships and at the bow, with the intention that the boat will float level if swamped

UPDATED Geoff Williams is building an Oughtred "McGregor" canoe – the 13'7" version. Now working on decks after deck beams fitted.

Peter Jensen is building an Oughtred 'Puffin'.

UPDATED Jon Elcock reno-ing an 18' Cecily Bowden Cruiserette- Wiring sorted, ordered new engine, picked up controls & gauges now being fitted then off to get engine fitted next.

NEW MEMBERS

A hearty welcome to:

Gary (Gaza) Barker, of Mountain Creek – Gary has recently completed and launched a Francois Vivier designed Ilur model sailing boat, 4.4m long with a balanced lug sail. Gary started the build in July 2015 and completed in August 2017. Gary heard about us via WBAQ member Paul Hernes. Here are some photos of Gary's quality lapstrake build:



Maurice (Maurie) Munro, of Cleveland – Maurie has a Kel Steinman designed 9.45 metre LOA yacht with ¾ sloop rig and 22 hp Kubota engine, built by Munro & Lanham, and launched in April 1986. Maurie built the boat in strip plank cedar using West System epoxy with E Glass, Kevlar and Carbon.

Maurie heard about us at the Brisbane Boat Show.

Laurie Davidson, of Mt Kynoch – In 2004 Laurie built a Scruffie Stornaway 18 foot day boat named “Enigma”, having a standing lug sail with mizzen and jib, and outboard; and currently has in build a Bill Garden designed 12’6” cat boat, strip planked, glassed inside and out. Hull and deck are complete and painted, and mast and spars are under construction. Laurie found us by a web search.

REPORTS

NOTE: All reports this month are brought to you by 3 IANS and one RON

THE MESSABOUT THAT WASN'T -LAKE MACDONALD

Ian Primrose

An old Norwegian adage says “*There is no such thing as bad weather – just bad gear*”. A contrary view is that the fewer clothes you have on, the more fun you will have. Read into that what you will, but it is the main reason Victorians flock to Queensland in winter. We had a wet week and nothing is slower than a wet week, especially if confined to a tent or caravan. So discretion prevailed and the Lake MacDonald Messabout was cancelled. However Phil & Elaine Brown did bravely take their van up in which they were mostly confined but they had a good few relaxing days, reading. The boat did not get in the water. Fortunately it was stored bottom-up. Lake MacDonald is a great place, but not so when it is raining a foot or so, as it has this past week. On the bright side- there will be more water for us to sail on in the dams!

BRISBANE RIVER ADVENTURE

Ian Mortleman



All aboard just after 8 30 am, and MV ATRIA sets sail out of Manly Harbour with 3 couples and skipper. Tides rising, light wind, cloudy all set for a trouble free run up the Brisbane River.

Pushed it along at good 6 ½ knots against the tide past St Helena Island turning south of Mud Island to enter the main shipping channel around 10 am, oops skipper misjudged that run should have been up at Colmslie by now to meet up with Kevin and Ian in CLIPPER and Phil and Elaine in PLAYSTATION and Ron and Geoff in GARVEY, launching from what is a quiet ramp with a pontoon. Powered on, past all the industrial areas to River side Marina and met up with everyone to continue in company towards the city. Throttled back now as tide assisting. PLAY STATION was doing well under sail with us. Unfortunately Ron and Geoff in GARVEY dropping back, slowed but needed to make City by midday which is what we do so right back on schedule.

We anchored upriver from Old Botanical Gardens pile moorings. Hello that's a Drone paying us a visit, circling us, up down round and round all three boats. I suspect taking photos but where from?

All three boats rafted up and crews came aboard ATRIA for lunch, and thanks to Phillip a lovely feed of large fresh prawns, yum we do it tough at times. The tide has turned, time to go everyone and the wind is rising, northerly not so bad we are in the river. Mind you, Kevin did say as a parting comment that the mouth of river was pretty rough the other day so he didn't venture out. Ok his boat smaller than ATRIA how rough can it get, we were about to find out. This is the life cruising down the river, now in excess of 8 knots with the outgoing tide admiring all the luxury homes right on the water edge,” I wonder if they get flooded,” isn't that steep land builders nightmare, how do they get building materials in I wonder” “isn't that sad, that was Normal Wrights old boat shed well what's left of it, all be housing shortly” All agreed the Brisbane River has a lot to offer, and well worth the run.

But it gets better , or does it, as we neared the mouth of the river just after the Gate way Bridge we encounter wind against tide thankfully on the nose, ATRIA driving into a half to 1 meter chop with 15 to 20 knot northerly, I see what you mean Kevin, it does get rough. Spray now going over the top of the cabin as we drive into the chop still doing 8 knots. “Do you think it will get any worse someone asks?” Well we do have to turn right shortly that means ATRIA will be beam onto this chop could get a bit of roll on. By now everyone else back on trailers or moored just ATRIA left to face the Moreton bay chop to get Manly. “Do you ever get anxious I am asked while deciding on best course” yep and this is one of those times.

So we turn right out of the main shipping channel, ok not so bad, oops not so good as a steep set comes though, ATRIA rolls everyone hangs on. So the fun starts setting a course for northern tip of Mud Island, yes I know we should be going to southern end, but angled into the chop which at times was a least a meter, minimising the roll and making life on board just a little more comfortable. Now who said to his wife come along it should be a nice comfortable cruise. Once over far enough to run with the slop we turned to make the northern end of St Helen Island and back to Manly to tie up in good time. Who needs to go to Dream World for roller coaster rides when you have Moreton Bay? And seat cushions that slide off the seat while you're sitting on them carpet that scrunched up under your feet, as you brace against each roll. Yet only the sounds of laughter echoed around the cabin and all arrived back safe and sound a jolly good day out was agreed by all.



BILLIES BAY, WIVENHOE

11th November

Ian Primrose & Ron Prescott

When the going gets tough, the tough go boating!

The forecast for the day was for strong winds and rain. This did not put off the intrepid crew who went to Billies Bay on Wivenhoe. Five boats and 10 people (some visitors) took to the water for some exciting sailing and rowing. By 12 noon, the wind was pumping 25-30 knots with a foot or so of chop on top. Billies Bay day area is new and is well facilitated with BBQs, shelters, WCs, and a good double ramp with more than adequate parking. It is under-utilised even at weekends. Its best feature is the steep wooded hills that surround the waterway. It is most picturesque with copious birdlife of black swans, shags, ducks and pelicans to name a few.

Despite the weather, it was a good day - far better than it would have been on the coast.



Jim Inglis in Girt by Sea making the most of the good sailing conditions

Ron Prescott writes...Those Attending:

4 sail boats- Geoff Williams, Jim Inglis (qualified for the longest drive if there was a prize); Bill ...:David Sloper. **Rowing:** Ian Primrose; **Paddle:** Ron Prescott **Visitors:** John and Roberta Morrison; Dave Micklethwaite, David Sloper's wife ??

Weather was quite cool, cloudy but no rain.

Considering our membership this was a small attendance, when there was a chance of exploring a new location with the safety of numbers. As it turned out, help launching and retrieving was most welcome with a surf directly onto the ramp. I would not recommend launching from this ramp if there is a Southerly wind. This was a surprise as we have sailed from there 3 or 4 times this year. I would like to recommend as our motto taken from "Paddler's Guide to Queensland" with a slight change. "We don't stop sailing because we grow old, we grow old because we stop sailing".

We spend many hours building, let's try and use them more.

WHISPERS FROM THE ISLAND (MACLEAY IS, THAT IS)

Ian Kirk

Numbers for Wednesday sailing have been low of late for various reasons.

But, over the last two weeks the recently retired Max Keily with his now brightly painted yellow Bolger Gypsy has been joining the Piccup Prams of Ivan Scott and I on the water. Max's Gypsy was built by Martin Kortluck some years ago.

With the three boats together on the water many of the traditional rainbow colours are on display. These boats will soon be rejoined by Bruce Morris' newly repainted Shimmy. I tried to encourage him to go purple but off white she is to be.

In the photo, Bruce, a keen sailor who has obviously been missing his desired recreational activity can be seen getting up close and personal with the Gypsy's dagger board.



The islanders and other Wednesday sailors are always keen for 'big island' visitors to join us. We keep a weather out towards Victoria Point on launching from the northern end of Macleay Island at around 9am. If any mainland boats are in sight we meet up between Coochiemudlo Island and Macleay to decide the direction of the day's sail.

If interested, feel free to contact me on 34095886 at any time.

Happy wooden boating, Ian Kirk.

MY SAILING MENTOR

Ian Kirk

How one man changed my life...

My mentor - the late, great Len Johnstone.

Having been forced into early retirement from my sport of Australian Rules football, sailing beckoned as a greatly different alternative activity.

A VJ was purchased to learn this sport and surprisingly three of my footy mates also became keen on sailing. The VJ, being an intermediate class for teenagers was way too small to accommodate four young men so the old 16 foot skiff 'The Red Baron' was purchased. A good deal of 'swimming' was 'enjoyed' so it was decided to join a club to gain some much needed skill. South Brisbane Sailing Club became our home and very fortunately were we to become members of such a friendly and supportive club.

While the members helped us in many ways to become competent and marginally competitive in what was a heavy old beast of a boat it was the gaining of our mentor Len Johnstone that had the most profound impact on our sailing. Len, a paraplegic from polio as a child was an amazing man and an incredible sailor. He skippered 16 foot skiffs, sailing mostly on the demanding Bramble Bay course, winning many titles against the best of fully able-bodied sailors. He couldn't hike out because of his legs so as he told me 'the sheet hand (main) had to be strong. One hand for

the sheet and one for my shorts to keep me aboard.' And this in an era of no buoyancy tanks. His major skiff victory you will find quite incredible.

Many a happy hour was spent on '*Marina*' his beautiful 30 foot catamaran discussing sailing and ways to perform better. Incidentally, Len's cat was built by John Wasson, a shipwright who did much work on the '*Forceful*' at the Maritime Museum.

So, Len would arrive at the Milton Reach and drive up and down the road edge in his automatic Toyota Crown calling instructions to us, his pupils. The only problem was that all the very good skippers followed his advice too minimising our advantage. He was there too the following year helping us set up the number 2 rig on the '*Lennie J*' which was named after him.

Then he was there again the following year when the crew of our boat morphed into two skiffs and we embarked on reintroducing the 16's to Sandgate. Len arranged for about 8 boats to be bought from Sydney (including mine) by liaising with old Skiffie friends there.

A few years later he was there again to provide guidance and a beautiful log book for our cruising ketch '*Wyuna*' when I embarked on the cruising lifestyle.

I think my life would be different had I not met Len- I would have missed out on years of boating pleasure and that would have been a loss indeed.

So, there is much more to say about this incredible man but I will leave that for you to discover in the article 'The Len Johnstone Story' by George Lestor that will soon be found on the WBAQ website.

Nautical terms in common use

At Loggerheads -

An iron ball attached to a long handle was a **loggerhead**. When heated it was used to seal the pitch in deck seams. It was sometimes a handy weapon for quarrelling crewmen.

Today, persons **at loggerheads** are simply in dispute or arguing (without the associated violence!).

WEBWATCH

GO BOATING WITHOUT GETTING WET

From Dave Micklewaihe

Rebuilding of 1910 Albert Strange Cutter "Tally Ho"

Plus a lot of other stuff

www.sampsonboat.uk

www.facebook.com/sampsonboat.co

"A video of the quintessential small American catboat, the **Beetle Catboat**, a 3.73 meter by 1.82 meter sailing dinghy based on the big Cape Cod working catboats. You can find Beetle Cats here and there up and down the East Coast, though most of the racing is found along the Massachusetts shore line. Very classy!"

<https://vimeo.com/239959828>

From Paul Hernes...

Building a historical 18ft skiff

Interesting video of the

build <https://youtu.be/kMaClFVOF30>

Found on this

website <http://www.openboat.com.au/index.html>

LAUNCHINGS



BRAVO / ZULU

Naval Flags meaning "Well Done"

DAVID SLOPER launched his Ross Lillistone designed Phoenix III at Caloundra on November 2nd



Photos by Paul Hernes

TIMBER FOR BOAT BUILDING

Compiled by Ian Primrose

SILVER QUANDONG (*Elaeocarpus grandis*.

Family: *Elaeocarpaceae*).

Common names: Blue fig, Blueberry Ash, Blue Quandong, White Quandong, Cooloon

A tall tree attaining height of 35m and a stem diameter up to 2m. The stem is buttressed

prominently at the base and covered with a grey, smooth, slightly wrinkled bark. The older leaves turn bright red before being shed and this can be used to recognise Silver Quandong in the forest.

Silver Quandong occurs along the eastern coast of Australia, most commonly between Taree NSW and Maryborough, Qld. Small populations also occur on the Eungella Range and between Ingham and Cooktown. A disjunct stand occurs beside the mouth of the Daly River, Northern Territory.

Quandong is a soft timber (rated 5 on a 6 class scale) in relation to indentation and ease of working with hand tools. Machines and turns well to a smooth surface. Can be satisfactorily bonded using usual glues, including epoxy. Seasoned timber will readily accept stain, polish and paint.

Once commonly used in joinery, mouldings and linings and also occasionally in general house framing, it is rarely used for these applications now. Mostly used for Plywood, furniture, shop and office fixtures, turnery, carving, inlay work, picture frames.

Suitable for small Boat building and boat oars (due to light weight) and especially useful for decorative features such as inlays when used in conjunction with darker timbers.

Although not readily available, it is a light versatile timber.

Density 495kg/M3 at 12% moisture

THE "CURVE COMPUTER"

Ian Primrose

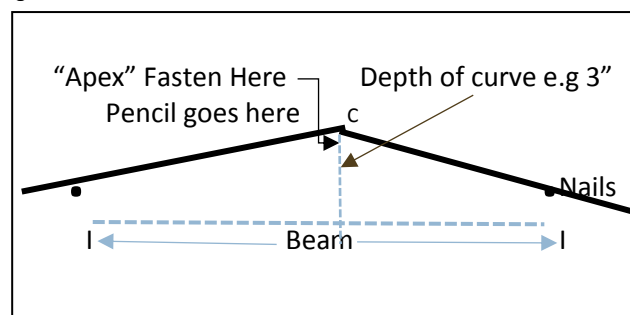

THE "CURVE COMPUTER"

This method can be used to obtain an accurate curve for decks and the like. It will determine an arc with a defined rise over a given distance.

You will need:

- A tape measure
- 2 battens each longer than the beam of your boat

- Hot glue (or slow glue if you can wait)
- 2 nails
- A sharp pencil
- Board on which to trace out your curve.

Method:

- Measure the beam of the boat and transfer to the board with a nail at each end;
- Determine the mid-point and from there, measure the amount of rise you require in your curve or deck e.g 3" over 4ft.
- Take your battens (remember they have to each be longer than the beam) and join them solidly at the mid-point with hot glue. We'll call this the "apex".
- Slide the apex down to one nail (Now, one arm of the batten will be horizontal, of course)
- Place your pencil at the inside of the apex
- Slide the apex in the direction of the other nail ensuring that the two arms of the "computer" stay in contact with the nails at all times.

With this simple device, you will be able to draw a fair and accurate curve.

"WATERPROOF" PVA GLUES

Geoff Williams has used the glue shown below to make deck beams – The advantage being that you don't have to wait as long for it to dry and it is not as messy as epoxy. Before doing the real ones, Geoff conducted a trial by putting test pieces in water for 24 hours. In trying to separate the pieces, the wood broke – not the glueline.



A similar test conducted with **Titebond III Ultimate Waterproof glue** (from Carbatec) **FAILED** at the glue line. In fairness, it does state on the bottle "not suitable for immersion". It seems there might be potential for using these glues in low stress areas that are not immersed.

Have you had any experience in using these glues? What do you think?

**THE WBAQ 2018 CALENDAR IS OUT
YOURS FOR ONLY \$10**

This is the 7th year that we have produced this limited edition calendar for the benefit of members.

Our thanks to Hannah Ford (daughter of member, Ross Obrien) who has given valuable expertise in making them a high-quality item.

It contains fantastic boating photos – this year there is a drone shot of "Skirmish" battling it out in the "Gaffers' race" on the Bay. There is a saying each month for you to ponder upon and a space to record all your boating activities so you don't forget them. They make excellent Christmas gifts.

All this for just \$10.

Sold at cost for the benefit of members.

Available at the December meeting.

Country Members: Yes, we will post if you cover the cost. Send your address and numbers required by email to info@woodenboat.org.au

We will advise costs and method of payment.

2017 BUILDERS' PLAQUES

URGENT Have you launched or relaunched a boat this year? To receive your trophy at the December meeting send detail to Phil Brown at 4165phil.b@gmail.com or info@woodenboat.org.au

By November meeting. Required information: Name, Boat Name, Date launched and photo.

CAPT. THUNDERBOLT AWARD

This perpetual award was created in honour of "**Chelsea**", the only wooden boat ever known to be struck by lightning on Lake Cootharaba. It is awarded (tongue-in-cheek) to the person who has had the greatest fail, best stuff-up or most embarrassing moment during the past year.

Send your nomination in 25 words or less to Phil Brown info@woodenboat.org.au

This prestigious 2017 award will be made at the December meeting. **DOB-IN SOMEONE NOW!**

MARITIME MUSEUM NEWS**FUNDING**

The Museum has secured a three year funding Agreement with the State Government through Arts Queensland. The Agreement was finalised and signed on 27th October 2017. The Agreement totals \$600,000 over three years with a combination of funding for

operations as well as capital expenditure to improve the site and collection.

The Agreement also opens the door for a much closer working relationship with the Queensland Museum. A committee will be formed from across both organisations and Arts Queensland to establish how the Queensland Museum can best assist the Maritime Museum to increase attendance and improve the visitor experience.

RESIGNATION

Museum CEO, Ian Jempson has resigned and is moving on to other employment. The WBAQ has had a close & good working relationship with Ian over many years and we wish him all the best in his new endeavours.

A VISIT TO ARMFIELD WOODEN BOATS AT GOOLWA

John Tennock

On our recent holiday in South Australia, Anne and I stayed briefly at my cousin's holiday house at Goolwa, just a short walk from Armfield Wooden Boats slipway and boat shed. Naturally we had to call in and meet the crew. The following notes from their facebook page and some pictures we snapped, may be of interest to WBAQ members.

Armfield Slip and Boatshed at Goolwa is run by a group of volunteers who maintain the skills of traditional small wooden boat building, particularly related to the Lower Murray. Its aims include fostering interest and enthusiasm in the building, restoration and use of wooden boats. The organisation, which is a member of the Australian Men's Shed Association, is supported by the Alexandrina Council.

Members work at the Armfield premises every Tuesday and on Friday afternoons on the restoration and maintenance of its fleet of boats. At times we undertake the building of new timber craft, some of which are offered for sale or as prizes in raffles to supplement our funds. A key part of the activities is the preservation of traditional small wooden boat-building skills.

Members also use Armfield's boats for displays and in assisting local tourism activities. From time to time craft can be seen out of the water on the slipway's trolley where they receive regular maintenance and repair.

Members and the boats are involved in the Goolwa Wooden Boat Festival every two years and Armfield Slip maintains close liaison with the Festival organising committee and with the South Australian Wooden Boat Association.

Projects under way in their well-equipped boat shed included restoration of a donated traditional wooden hull, construction of a raffle prize for the next festival and production of simple model kits sold as a fund-raising and wood-working skills exercise.

Mold for the raffle prize



Model kit and models

WHAT HAPPENED AT THE LAST MEETING

Member, Mark Fort gave us a talk on his September visit to the 41st Wooden Boat Festival at Port Townsend Washington State USA. Lots of boats, large schooners, informative talks and demos and a quick & dirty competition. Port Townsend is located on the West Coast with a harbour protected by islands. Great location, Mark says but the show was smaller than the Festival in Tassie.

NEXT MEETING

December meeting will be our Christmas get-together where wives/ partners are most welcome to join in. No charge for the meal and great raffles for hampers will be a highlight. Awards for builds will be handed out and it will be a casual night.

For catering, please advise

Phil Brown 0416 057 277 4165phil.b@gmail.com or info@woodenboat.org.au of numbers if you are attending.

Boats on display at Caloundra Powerboat Club's 40th Anniversary-

Photo Jim Jones

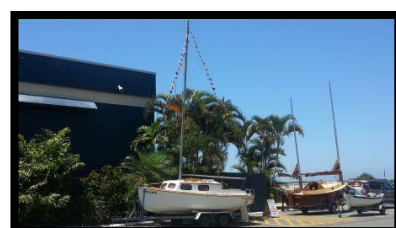

2017 CALENDAR OF MESSABOUTS & EVENTS

One day, weekend and week-long Messabouts and big events in 2017-18

NOTE: Due to the wide range of boat sizes and types, and relative seaworthiness, it always remains the Skipper's decision whether to participate or not. Aim to launch & depart from ramps by 0900 hrs unless otherwise advised. All week long events have a "Plan B" to be Wivenhoe Dam or Atkinson's Dam. For last minute information contact the nominated organiser (listed below) or a Messabout Committee member: Darrell Spiers 3298 5394 Phil Brown: 3820 8082

If you are intending to go to a Messabout, Please advise the Host in case there are any last-minute changes (due to weather or other unavoidable changes).

Type of Event: P= Paddle, R= Row, S= Sail, M= Motor Brackets () indicate possible but not recommended

MONTH	TYPE	MESSABOUT	EVENTS
NOVEMBER	P,R,S P,R,M	➤ 26 th Lake Samsonvale John Tennock 0428 439 001 – See note below ➤ Wed.29 th Deep Water Bend Pine River Ian Primrose 3263 3381 / 0491 120 888	SPECIAL EVENT: Thursday 23 rd NOVEMBER Visit to Mt Gravatt Mens' Shed at Mt Gravatt Showground. Great Shed full of stuff. Meet at 9.30 Host Leo Sines 3843 1422 / 0418 781 755
DECEMBER	P	➤ DECEMBER MEETING – Christmas Get-together- Wives/ partners welcome ➤ 16 th Enoggera Reservoir, Bne Forest Park	
2018	N/a P,S,R P,R,M P,R,M	JANUARY MEETING ➤ Jan 20 th Lake Wyaralong ➤ 17 th Feb Cabbage Tree Creek Paddle ➤ 3 rd March Coomera River ➤ 18-20 May Bribie Classic Regatta	Yes, We are holding a meeting in January following the success of the one this year

CALLING ALL MID-WEEK SAILORS-

Jim Jones is compiling a list of persons who would be interested in sailing, rowing – just general boating mid-week. Zone co-ordinators wanted too.

Contact Jim at aeroservice@bigpond.com or phone 0408 443 291



COMING EVENT DETAILS

Mark your calendar now

SUN 23rd Nov Sail/ paddle/ picnic day at Lake Samsonvale Water Sports Assoc

NOTE- Keyed gate so you must arrive between 0930 and 1000 and depart 1500-1530 or by arrangement. Look for sign on Winn Rd approached either from Strathpine along Samsonvale Road or from Samford and Closeburn along Mount Samson Road. It takes about 10 minutes to drive from either Strathpine or Samford to the locked gate, and a few more minutes down a well-maintained forest track. Lovely spot for a family day. John Tennock 0428 439 001 (Possible alternate keyholder Chris Reid 0417 703 121)

29th November (Wednesday) 9.30 DEEP WATER BEND on the Pine River - Tinchy Tamba Wetlands Park, Wyampa Rd, Bald Hills. Low tide 12.20pm so a runout tide to take us to the direction of the Ted Smout Bridge and back with the tide after lunch. Ian Primrose 3263 3381 / 0491 120 888

16th December Enoggera Reserve / Brisbane Forest Park. A paddle on the dam or a swim. A carry of boats for 300m is necessary. Picnic lunch – a good kids and family day. Info Ian primrose 0491 120 888



WBAQ MARKETPLACE

Members - advertise for free here for 3 months! Boats, tools, accessories etc

WBA Qld accepts no responsibility for the accuracy of the information provided by the vendor, nor can it act as an agent in relation to any item listed. It remains the responsibility of the vendor and the buyer to verify the accuracy of information posted and to agree on the details of sale

BRING / BUY / GIVE-AWAY TABLE AT EVERY MEETING – Clear your pre-loved items and transfer them to another more needy member. Mark items with name and price. No commission – free service! See Leo Sines – Merchandise Co-ordinator

WBAQ MERCHANDISE Identify your boat or yourself with WBAQ signage.

Cloth Badges \$8; Stick-on labels 50cents. Metal Plaques MkII \$10.

BURGEES \$15.

NEW... WBAQ Pennants – Dress your boat -just \$10

See Leo at the Merchandise Table at every meeting



ROPE. Available to members at cost. 6mm - .70c; 8mm-\$1; 10mm-\$1.20 per metre.

Suitable for rigging or general use. Also 3mm cord in spools – only \$3 while stocks last.

Order before the meeting by phoning Leo Sines 3843 1422 or 0418 781 756 ejsines@bigpond.com

NEWFREE BUILDING STAND 3650mm long and about 300 wide. Great for small boat, spar or oar making. Free to collect from David Sloper at Durack Ph 0400 288 719

2 SEAGULLS

- Forty plus made Sept 1975 4 Blade Prop Good Working order. \$150 neg
- Silver Century May 1974 5 Blade Prop – Seized (could be just emulsified gearbox) \$50 neg

Contact Mac Campbell 0449 636 201

SOLD MARSH CAT 14' Sold to Kingaroy local!

THORPE SAIL BOAT about 12' Other details not known but a give-away

Contact Phil Brown 0416 057 277

FOR SALE Belle is a 16 ft skiff probably built in the early 70s. Double diagonal cedar that is clear varnished inside and out. The hull has been glassed and a small foredeck added. She comes with 2 masts and 3 sets of sails. She can be rowed and I have an outboard bracket for up to 5hp motor. On a registered trailer. Asking for \$2500
For more info call Matt on 0421819997.



GOOD ONE! PRICE REDUCED! For Sale \$6500. Reduced to \$5,200 ono Hartley TS16 "Zero One", built stitch and glue, stronger, lighter and more room inside. Full set of sails, main, two jibs, roller reefing on the jib. Some spare sails if you want, spinnaker & jibs All rigging, including spinnaker pole and a spare mast with some fittings. 6 HP Suzuki four stroke very low hours, Bimini cover. Boat and trailer registered 'til February 2018 Loads of buoyancy. Located Rochdale Sth Jon Elcock 0413 945 377

Under reefed sail



Bimini shown



BARGAIN! GOAT ISLAND SKIFF Hull near completed; Full size plans available. All proceeds to be donated to WBAQ. Trailer not included but can deliver within Brisbane area. Only \$500 ono. Contact Ian Mortleman 0413 457 656



GIVEAWAY Vee Jay "Impetuous" No 822 All the bits are there including main and jib but hull needs a bit of work. Also included is the building manual. **Contact marie.hurley@glenmountsiding.com**





FOR SALE NUTSHELL DINGY It was built by an apprentice at the wooden boat school approx 10 years ago.. It is in its raw state and it has never been launched. I am asking \$500 it cost me \$650. And I am certainly prepared to negotiate. Barry Kairl 0418711462. (Overseas until end Oct)



FOR SALE I have an 18 ft cold moulded strip planked Huon pine half cabin boat built by my father, which I am looking at selling in the future. It is a "putt putt" boat with a Brand-NEW inboard 2 cylinder 2-stroke Blaxland engine with an expanding sleeve engagement mechanism for the propeller shaft. It has never been used and needs a cabin and painting. The hull is complete along with the deck, rudder, tiller, engine cover, floor panels and seating. It is on a trailer at the moment in storage. Gavin 0427 958 450



MASSIVE BOATING SALE!

Ulua, a **double outrigger** by Gary Dierkin designs.. 5400mm. Strip planked in hoop pine . \$1800. Neg. No trailer.

Macgregor sailing canoe. Iain Oughtred design 4140mm. Strip planked in Qld red cedar. \$1600 Neg.

Spinnaker pole 2280 x 52 \$75.

Oars 2000mm. With stops and rowlocks \$25

Sand anchors regalved. 7kg \$25 & 9kg \$30

Outboard Mariner 3.3 \$200

Barlow15 winch \$50 All items neg. Rob Mabin 07 5445 2958 or 0427 452 958

rmab2439@bigpond.net.au



CLEARANCE Bill Rowland is downsizing. All sorts of boats Big & Small -Contact Bill 0402 088 488 for details

FREE SABOT with hand trolley Located Ferny Grove - Chris Reid 0417 703 121 creid@bigpond.net.au

34ft MILLKART CRUISER Gaff Rig 1964 Hoop pine & hardwood 3cyl Lister Don Marshall 3366 5166

FOR SALE Hartley 16 It is need of a lot of TLC, the transom needs to be replaced. The rest of the timber is in fairly sound condition. The interior of the cabin and the bones of the hull are in good condition. The decks could do with replacing, but not necessary. With unreg Trailer. Only \$500- Located Golden Beach Darrell & Sue Kerkow daskerkow@bigpond.com



Boatcraft Pacific (Advertisement)

The best source for all your boat building materials.

- Bote-Cote marine coating resins. 2:1 Amine blush free optimised for Australian conditions
- Epox-E-Glue A pre gelled 1:1 epoxy glue.
- Purbond Single pack waterproof adhesive ideal for strip planking and joinery.
- Aquacote Water based high build epoxy primer and water based 2 pack polyurethane top coat. Very high performance two pack paints without the fumes and health worries.
- Cop-R-Bote antifouling. Copper metal permanent antifoul that really works.
- Fibreglass Woven and knitted reinforcements, the widest range of weights and constructions.
- Timber and Plywood. Marine plywood and long length clear hoop pine, WRC and Kiri.
- Silicone Bronze and Copper fastenings. The largest range in Australia.
- Davey traditional bronze ship and boat fittings. Plans. We can supply a wide range of boat plans. Come and browse our catalogues.

Save money with our material packages.

46 Chetwynd St Loganholm, Qld 4129 Ph 3806 1944 Fax 3209 7711

Be sure to tell us you are a WBAQ Member to receive a 7.5% discount from Trade price

BoatCraft Pacific (Sunshine Coast) (Advertisement)

Sunshine Coast boatbuilders !

BoatCraft products now available ex stock from our Noosaville location

Bote-Cote Epoxy – Epoxy Glue - Purbond – Aquacote – Fibreglass – Timber – Marine plywood

Shed 3, 7 Bartlett St, Noosaville 4566 Tel 0405 385 194 (call to check opening times)